



### GENERAL PROPERTIES

Built-In / Fully-Integrated Tall Tub  
 Panel Ready  
 Stainless Steel Interior

### FEATURES

Top hidden controls  
 14 Place settings  
 Third level cutlery rack  
 Delay timer  
 8 Wash cycles  
 Quiet operation: 47 dB  
 3-in-1 Compatible washing tabs  
 Half Load  
 Detergent and Rinse aid dispenser  
 In-Line concealed water heating element  
 End of program indicator

### PROGRAMS

Regular  
 Auto  
 Intensive & Intensive Plus  
 Daily  
 Delicate  
 Super  
 Rinse

### OPTIONS

Half Load  
 Extra Dry  
 Extra Rinse  
 Sanitize  
 Hi-Temp

### TECHNICAL DETAILS

#### Product dimensions in inch (W/H/D)

23<sup>9</sup>/<sub>16</sub>" / 33<sup>7</sup>/<sub>8</sub>"-35<sup>7</sup>/<sub>8</sub>" / 22<sup>7</sup>/<sub>16</sub>"

598mm / 860mm-910mm / 570mm

#### Cut Out dimensions in inch (W/H/D)

23<sup>5</sup>/<sub>8</sub>" / 33<sup>7</sup>/<sub>8</sub>"-35<sup>7</sup>/<sub>8</sub>" +ops 1<sup>7</sup>/<sub>8</sub>" / 22<sup>7</sup>/<sub>16</sub>"

600mm / 860mm -910mm+ops 50mm / 570mm

#### Electrical Requirements

120 V / 60 Hz / 15 Amp

**Total Power/Heater Power:** 1,400 Watts / 1,100 Watts

**Water Pressure:** 43.5-145 psi (0.3-10 bars)

**Energy Consumption:** 270 kWh/yr.

ENERGY STAR®

## Features & Benefits

### Top Control Panel

Controls are located on the top of the door, providing a cleaner look to better integrate into your kitchen.

### Quiet Performance

Advanced sound absorbing construction operates at 47 dB.

### Stainless Steel Interior

Durable interior ensures long-lasting use.

### Third Level Cutlery Rack

Easily load cutlery to optimize space.

### Fold-down Tines

Rack includes two tines that can be folded down to make room for large items, or raised to hold dishes in place.

### Two Spray Arms

Improved design to ensure both racks are properly cleaned.

### Panel-Ready Door

Unfinished door is design to accept your own panel and handle, creating a seamless look to blend into your kitchen cabinetry.

### 8 Wash Programs

Settings include Regular, Auto, Intensive, Daily, and more.

### Half Load Function

Operates more efficiently for smaller loads of dishes.

## Installation Details

### PRODUCT DIMENSIONS (INCH/MM)

Width: 23<sup>9</sup>/<sub>16</sub>" / Height: 33<sup>7</sup>/<sub>8</sub>"-35<sup>7</sup>/<sub>8</sub>" / Depth: 22<sup>7</sup>/<sub>16</sub>"

Width: 598mm / Height: 860-910mm / Depth: 570mm

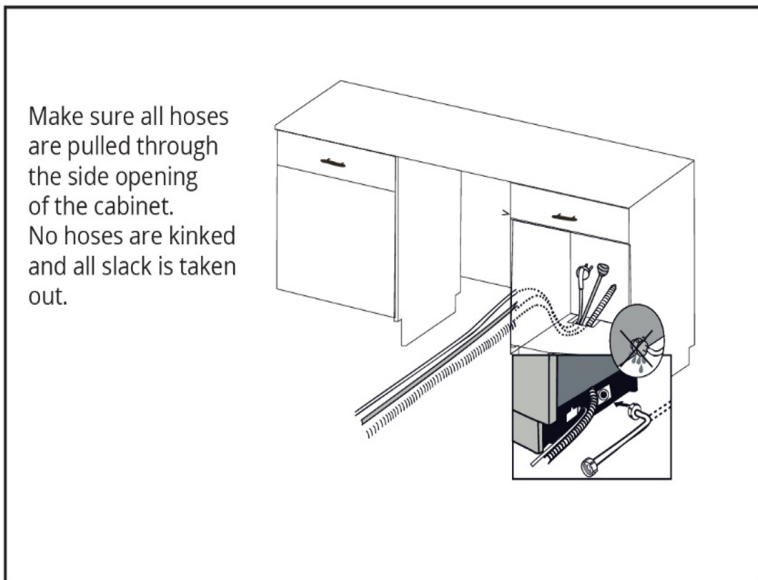
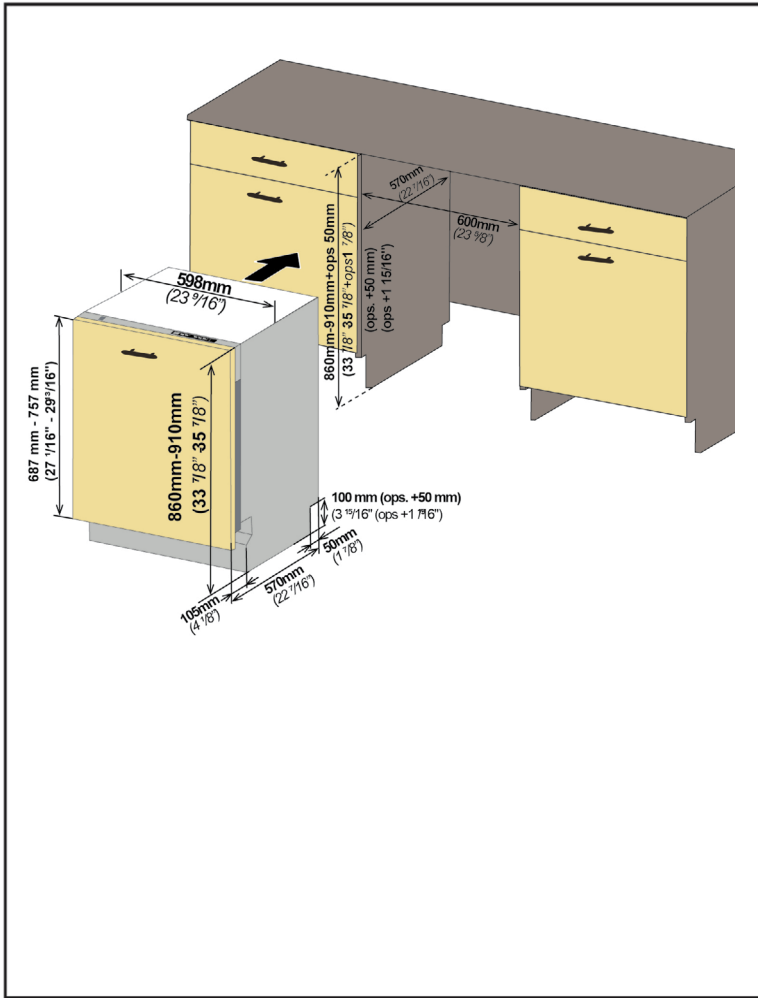

### CUT-OUT DIMENSIONS (INCH/MM)

Width: 23<sup>5</sup>/<sub>8</sub>" / Height: 33<sup>7</sup>/<sub>8</sub>"-35<sup>7</sup>/<sub>8</sub>" + ops 1<sup>7</sup>/<sub>8</sub>" / Depth: 22<sup>7</sup>/<sub>16</sub>"

Width: 600mm / Height: 860-910mm + ops 50mm / Depth: 570mm

#### Drain Hose Connection, Water Supply and Electrical Connections

1. Drain Hose - There are several ways to insert the drain hose into the connector of the sink, as shown in the following figures. Ensure you connect the drain hose in accordance with the water pipe regulations in your region.

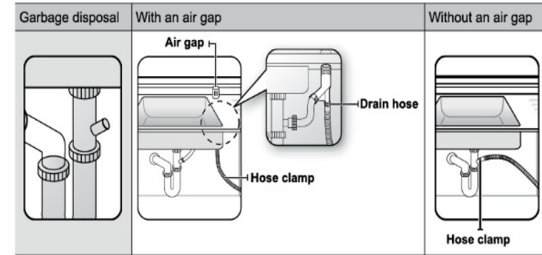

A. Without Disposal

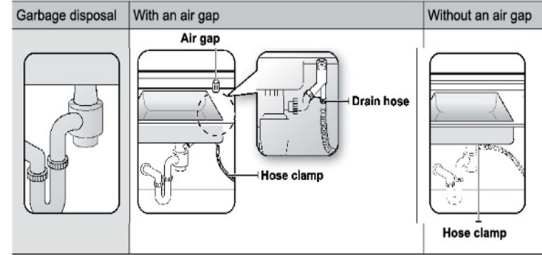

B. With Disposal

2. Check the size of the sink's drain hose connector. If needed, cut the drain hose so its end fits onto the sink connector (5/8", 3/4", or 1" as shown in (C) below). If the end of the drain hose does not fit onto the drain hose connector of the sink, use an adaptor purchasable at a plumbing/hardware supply store.

3. Slide hose clamp over the end of the drain hose. Attach drain hose to the sink connector and tighten the clamp. You must use a hose clamp. Failure to do so may cause water leakage.

4. If there is no air gap, make sure to hand the middle of the drain hose well above the sink cabinet base to prevent back flow (see Figure E below).

5. When drilling a hole for the drain hose on the cabinet wall, take caution not to damage the drain hose by sharp edges of the hole. Use sanding to soften wooden edges, use insulation tape or duct tape for metal walls to cover the sharp edges around the hole. To prevent leaks or drainage, make sure the drain hose is not damaged, kinked, or twisted.

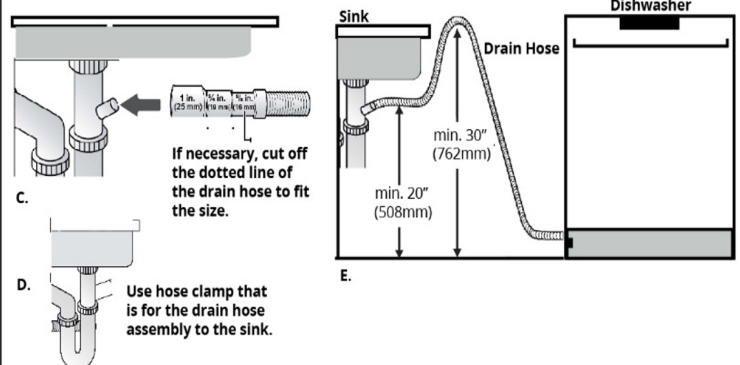



#### WARRANTY INFORMATION

Porter & Charles Appliances are designed and manufactured to the highest standards. Each appliance is covered by a comprehensive 2-year parts and labour warranty. Refer to product warranty policy for complete terms and conditions.

#### FOR PARTS & SERVICE

Euro-Parts & Service  
39822 Belgrave Road, Belgrave, ON. N0G 1E0 1 866 722 2262  
[www.euro-parts.ca](http://www.euro-parts.ca) • [parts@euro-parts.ca](mailto:parts@euro-parts.ca) • [service@euro-parts.ca](mailto:service@euro-parts.ca)

Porter & Charles appliances are imported and distributed in North America by Euro-Line Appliances Inc. For more information, please visit one of our showrooms or [www.ela.ca](http://www.ela.ca) / [www.elawest.ca](http://www.elawest.ca)

#### **EURO-LINE APPLIANCES INC.**

871 Cranberry Court, Oakville, ON  
L6L 6J7 Canada  
905.829.3980  
1-800.421.6332  
[info@ela.ca](mailto:info@ela.ca)

#### **EURO-LINE APPLIANCES INC.**

101-1014 Homer Street, Vancouver, BC  
V6B 2W9, Canada  
604.235.3980  
1-855.ELA.WEST (352.9378)  
[infowest@ela.ca](mailto:infowest@ela.ca)