

INSTALLATION INSTRUCTIONS

BEFORE STARTING YOUR APPLIANCE, READ AND FOLLOW THESE IMPORTANT INITIAL STEPS.

ELECTRICAL CONNECTION AND CLEARANCE:

- **This appliance is designed to be free standing only and should not be recessed or built-in.**
- Place your freezer on a floor that is strong enough to support the freezer when it is fully loaded.
- To allow proper air circulation, allocate 20cm (8") of space on each side of the unit, 10cm (4") in the back and 30cm (12") on top of clearance to allow the proper air circulation.

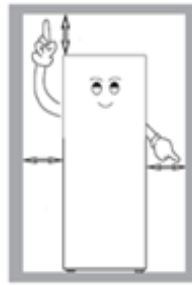

- Place the freezer away from direct sunlight and sources of heat (stove, heater, radiator, etc.). Direct sunlight may affect the acrylic coating and heat sources may increase electrical consumption.
- Extreme cold ambient temperatures may also cause the freezer not to perform properly.
- Avoid locating the freezer in humid areas.

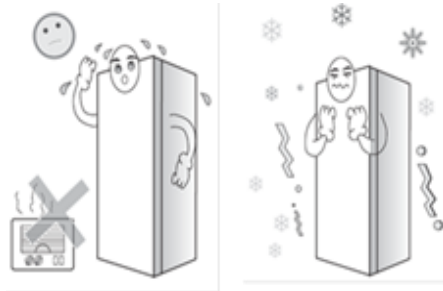

- Plug the freezer into a separate, properly installed-grounded wall outlet. Do not under any circumstances cut or remove the third (ground) prong from the power cord.
- Any questions concerning power and/or grounding should be directed toward a certified electrician or an authorized Service Center.
- Do not use this appliance with an extension cord or adaptor.
- **Be careful not to damage the shelving grids as they contain refrigerant liquid.**

UNPACKING AND CLEANING YOUR APPLIANCE

- Remove wrapping, tape and any labels from your appliance before using (except the rating label).
- Do not use sharp instruments, rubbing alcohol, flammable fluids or abrasive cleaners to remove tape or glue. These products can damage the surface of your unit.
- Clean your freezer before usage. Use a sponge, cloth or paper towel and mild detergent in warm water to clean outside and inside of freezer, door liner and gasket. Rinse and dry thoroughly.
- **Once plugged in, allow the freezer to cool completely for 2 to 3 hours before filling with frozen food.**

INSTALLATION INSTRUCTIONS (CONTINUED)

REVERSING THE DOOR

Tool required: Philips screwdriver, flat-bladed screwdriver, hexagonal spanner.

- Ensure the unit is unplugged and empty.
- To take the door off, it is necessary to tilt the unit backwards. You should rest the unit on a solid surface so that it will not slip during the door reversing process. Do not lay the unit flat as this may damage the coolant system.
- All parts removed must be saved to be reused for reinstallation of the door.
- We recommend that 2 people handle the unit during assembly.

1. Remove two screws at rear side of top cover.

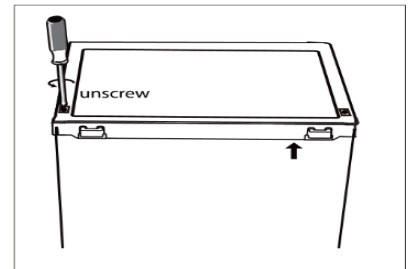

2. Remove the top cover and the thermostat knob, then place it aside.

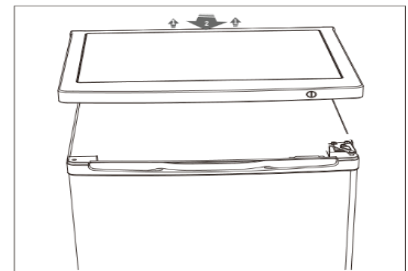

3. Unscrew top hinge and then remove door. Place it on a soft, padded surface to avoid scratching.

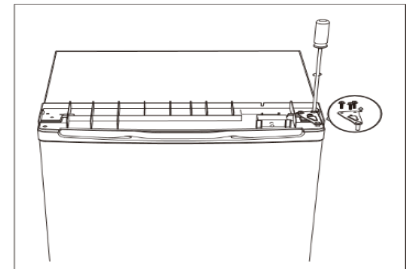

4. Unscrew bottom hinge. Then remove the adjustable feet from both sides.

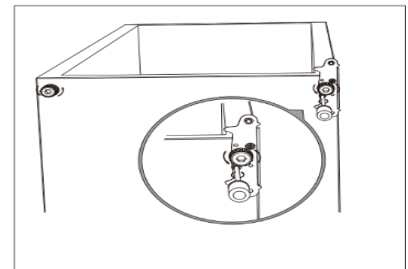

INSTALLATION INSTRUCTIONS (CONTINUED)

REVERSING THE DOOR (CONTINUED)

5. Unscrew and remove the bottom hinge pin, turn the bracket over and replace it.

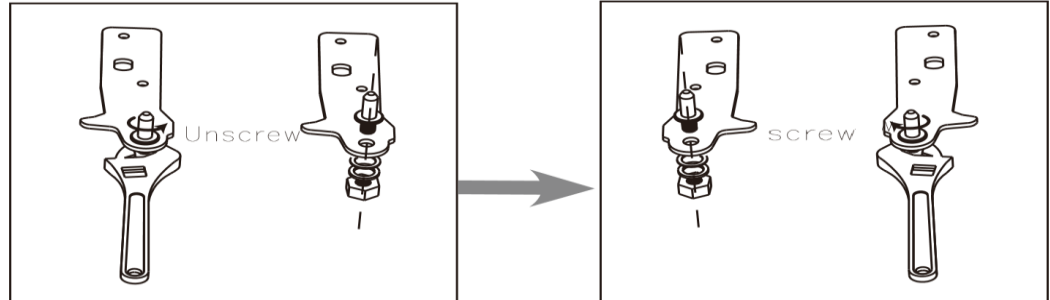

6. Refit the bracket fitting the bottom hinge pin. Replace both adjustable feet.

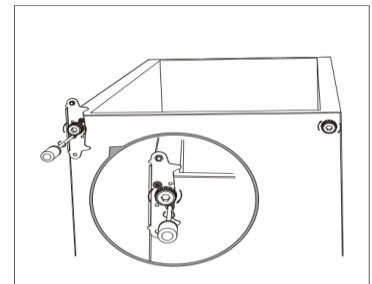

7. Place the door back on. Ensure the door is aligned horizontally and vertically, so that the seals are closed on all sides before finally tightening the top hinge.

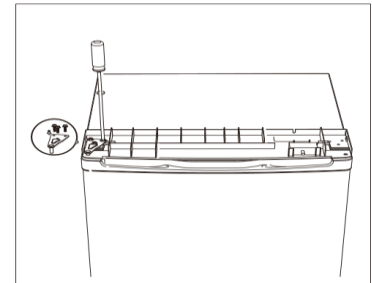

8. Put the top cover and fix it with 2 screws on the back.



9. Put the thermostat button back on.

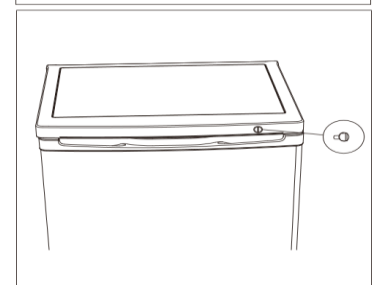

INSTALLATION INSTRUCTIONS (CONTINUED)

LEVELLING

If the unit is not leveled, the doors may not close or seal properly, causing cooling, frost, or moisture problems. It is very important for the unit to be level in order to function properly. To level your unit, you may either turn the level leg clockwise to rise the unit – clockwise to lower.

OPERATING YOUR APPLIANCE

USING YOUR FREEZER

When using the freezer for the first time or after defrosting, turn the temperature control to setting **MAX** for at least two hours before introducing the food to be stored. Let the freezer cool overnight before adding large amounts of **unfrozen food**. Never add more than 2-3 pounds of unfrozen food per cubic foot of freezer space.

All frozen food products you purchase should be placed in the freezer as soon as possible to avoid the frozen food from defrosting.

To obtain the best possible results from your appliance, it is important that you know how the mechanism works.

TEMPERATURE SETTING

- Plug on your appliance. The internal temperature is controlled by a thermostat. There are 3 settings: **MIN**, **NORMAL** and **MAX**. **MIN** is warmest setting and **MAX** is coldest setting.
- The appliance may not operate at the correct temperature if it is in a particularly hot or if you open the door often.

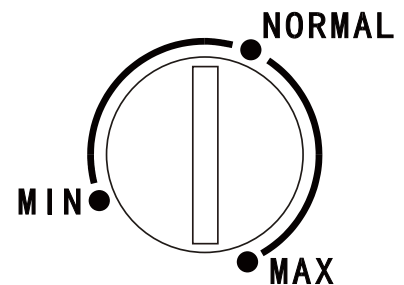

NOTES:

Turning the temperature control to the "OFF" position stops the cooling cycle but does not shut off the power to the freezer.

If the unit is unplugged, has lost power or is turned off, you must wait 3 to 5 minutes before restarting the unit. If you attempt to restart before this time delay, the freezer will not start.

Large amounts of food will also lower the cooling efficiency of the appliance.